

HAM-LET PRECISION INSTRUMENT PIPE FITTINGS

PIPELINE



GENERAL

The HAM-LET Pipeline range of connectors is manufactured for typical applications in chemical and petrochemical processing plants, as well as oil, gas and power generation industries.

FEATURE

- Sizes range from 1/16" to 2".
- Fittings are properly packaged with the exposed threads protected to ensure they are not damaged during delivery.
- All pipe threads meet the requirements of ASME/ANSI B1.20.1 (1983) for tapered pipe threads (NPT).
- Working pressures are calculated in accordance with Power Piping Code ANSI B 31.1, Refiner Piping Code ASME/ANSI B 31.3 and section VIII of ASME Boiler & Pressure Vessel Code.

PRESSURE RATINGS (PSI)

NPT or BSPT/ISO size	STAINLESS STEEL 316		BRASS	
	male	female	male	female
1/16	11000	6700	5500	3300
1/8	10000	6500	5000	3200
1/4	8000	6600	4000	3300
3/8	7800	5300	3900	2600
1/2	7700	4900	3800	2400
3/4	7300	4600	3600	2300
1	5300	4400	2600	2200
1 1/4	6000	5000	3000	2500
1 1/2	5000	4600	2500	2300
2	3900	3900	1900	1900

MATERIALS

MATERIAL	Specifications	
	Barstock	Forgings
STAINLESS STEEL 316	ASTM A-276	ASTM A-182
	ASTM A-479	
BRASS	ASTM B-453	ASME B-283
	ASTM B-16	
	DIN 176.60	

INSTALLATION INSTRUCTIONS

To ensure a leak-tight seal, HAM-LET recommends the use of a pipe thread sealant on all NPT threads. The most effective sealing method is PTFE tape. Tape should be used only on male tapered pipe threads.

Do not use tape on flared, coned or tube fitting ends!

Clean both male and female tapered threads and wrap tape in the direction of the male tapered thread spiral.

Note: Two wraps are suggested for stainless steel tapered pipe threads. Make sure tape does not overhang the first thread, as the tape might shred and enter the fluid system.

Cut off excess tape. The connection is now ready for proper makeup.

PIPELINE INDEX

ELBOW 100 H 4 MALE ELBOW 100 HM 4 TEE 101H 4 MALE TEE 101HM 5 CROSS 102H 5 HEX COUPLING 103H 5 UNION BALL JOINT 104H 6 HOLLOW HEX PLUGS 107H 6 HOLLOW HEX PLUGS SAE/MS STRAIGHT THREAD BOSS 107HOB 6	PIPE CAP 108H 7 REDUCING BUSHING 110H 7 REDUCING BUSHING SAE/MS STRAIGHT THREAD BOSS 110HOB 8 HEX LONG NIPPLE 113H 8 STREET ELBOW 116H 9 HEX REDUCING COUPLING 119H 9 ADAPTER NPT 120H 10 ADAPTER NPT FEMALE TO MALE BSPT 120HNR 10 ADAPTER FEMALE NPT TO MALE BSPP 120HNG 11	ADAPTER NPT TO SAE/MS STRAIGHT THREAD BOSS 120HNOB 11 ADAPTER FEMALE BSPT TO MALE NPT 120HRN 11 GAUGE ADAPTER FEMALE BSPP TO MALE NPT 120HGN 12 PIPE PLUG NPT 121H 12 HEX HEAD PLUG SAE/MS STRAIGHT THREAD BOSS 121HOB 12 HEX NIPPLE 122H 13 HEX NIPPLE MALE NPT TO MALE BSPT 122HNR 13 HEX NIPPLE MALE NPT TO MALE BSPP 122HNG 14 HEX NIPPLE NPT TO SAE/MS STRAIGHT BOSS 122HNOB 14	CLOSE NIPPLE 122HCN 14 REDUCING NIPPLE 123H 15 BRANCH TEE 3600H 15 STREET TEE 3750H 16 MALE HOSE CONNECTOR 130HM 16 FEMALE HOSE CONNECTOR 130HF 17 TUBE TO HOSE CONNECTOR 130LT 17
---	---	---	---

ORDERING INFORMATION

EXAMPLE:

120H	Material Description	1/2	x	1/4
	SS - Stainless Steel 316			
	B - Brass			

All orders should include ordering information and material description.

100 H ELBOW

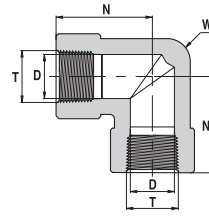

Ordering Information	T Female NPT size	N		D Min. Opening		W Wrench Flat
		inch	mm	inch	mm	
100H _ 1/8	1/8	1.04	26.4	0.31	7.8	5/8
100H _ 1/4	1/4	1.17	29.7	0.41	10.5	11/16
100H _ 3/8	3/8	1.42	36.1	0.56	14.2	15/16
100H _ 1/2	1/2	1.56	39.6	0.69	17.4	1 1/8
100H _ 3/4	3/4	1.92	48.8	0.90	22.9	1 3/8
100H _ 1	1	1.91	48.5	1.13	28.7	1 11/16

100 HM MALE ELBOW

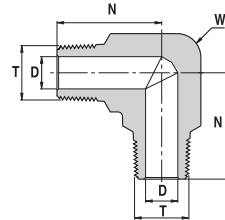

Ordering Information	T Male NPT Size	N		D Min. Opening		W Wrench Flat
		inch	mm	inch	mm	
100HM _ 1/8	1/8	0.88	22.4	0.19	4.8	1/2
100HM _ 1/4	1/4	1.05	26.7	0.28	7.1	5/8
100HM _ 3/8	3/8	1.17	29.7	0.38	9.6	13/16
100HM _ 1/2	1/2	1.45	36.8	0.47	11.9	15/16

101 H TEE

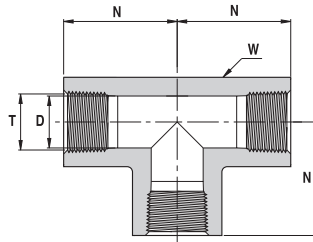

Ordering Information	A Female NPT Size	N		D Min. Opening		W Wrench Flat
		inch	mm	inch	mm	
101H _ 1/8	1/8	1.04	26.4	0.31	7.8	5/8
101H _ 1/4	1/4	1.17	29.7	0.41	10.5	13/16
101H _ 3/8	3/8	1.42	36.1	0.56	14.2	15/16
101H _ 1/2	1/2	1.56	39.6	0.69	17.4	1 1/8
101H _ 3/4	3/4	1.92	48.8	0.90	22.9	1 3/8
101H _ 1	1	1.91	48.5	1.13	28.7	1 11/16

"D" Dimension is minimum opening. Dimensions are for reference only, and are subject to change without notice.

101 HM MALE TEE

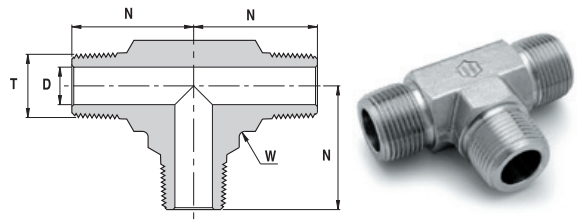

Ordering Information	T Male NPT Size	N		D Min. Opening		W Wrench Flat
		inch	mm	inch	mm	inch
101HM_ 1/8	1/8	0.88	22.4	0.19	4.8	1/2
101HM_ 1/4	1/4	1.05	26.7	0.28	7.1	5/8
101HM_ 3/8	3/8	1.17	29.7	0.38	9.6	13/16
101HM_ 1/2	1/2	1.45	36.8	0.47	11.9	15/16

102 H CROSS

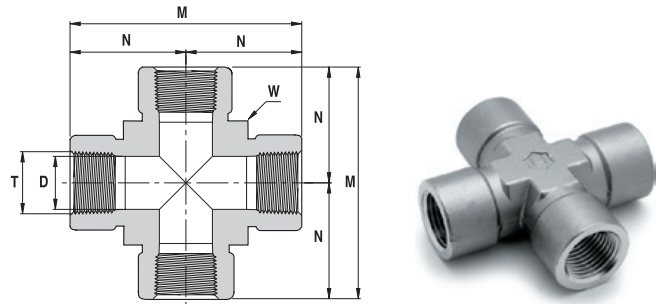

Ordering Information	T Female NPT Size	N		M		D Min. Opening		W Wrench Flat
		inch	mm	inch	mm	inch	mm	inch
102H_ 1/8	1/8	1.04	26.4	2.08	52.8	0.31	7.8	5/8
102H_ 1/4	1/4	1.17	29.7	2.34	59.4	0.41	10.5	11/16
102H_ 3/8	3/8	1.42	36.1	2.84	72.2	0.56	14.2	13/16
102H_ 1/2	1/2	1.56	39.6	3.12	79.2	0.69	17.4	1
102H_ 3/4	3/4	1.92	48.8	3.84	97.6	0.90	22.9	1 1/4
102H_ 1	1	1.91	48.5	3.82	97.0	1.13	28.7	1 11/16

103 H HEX COUPLING

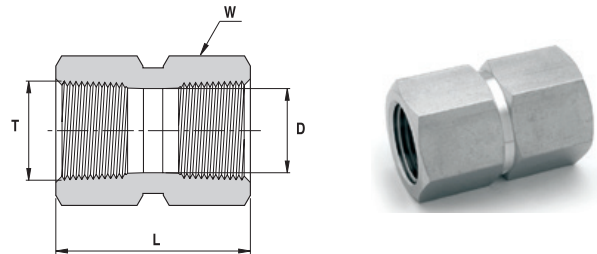

Ordering Information	T Female NPT Size	L		D Min. Opening		W Hex. Flat
		inch	mm	inch	mm	inch
103H_ 1/8	1/8	0.81	20.6	0.31	7.8	9/16
103H_ 1/4	1/4	1.19	30.2	0.41	10.5	3/4
103H_ 3/8	3/8	1.31	33.3	0.56	14.2	7/8
103H_ 1/2	1/2	1.56	39.6	0.69	17.4	1 1/16
103H_ 3/4	3/4	1.62	41.1	0.90	22.9	1 5/16
103H_ 1	1	2.00	50.8	1.13	28.7	1 5/8

"D" Dimension is minimum opening. Dimensions are for reference only, and are subject to change without notice.

104 H UNION BALL JOINT

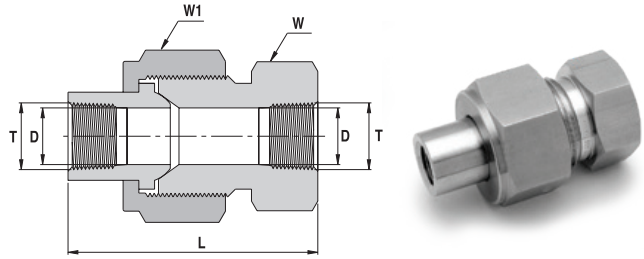

Ordering Information	T Female NPT Size	L		D Min. Opening		W Hex. Flat		W1 Hex. Flat
		inch	mm	inch	mm	inch	mm	
104H _ 1/8	1/8	1.81	46.0	0.27	6.9	15/16	23.81	1 1/8
104H _ 1/4	1/4	2.34	59.4	0.36	9.1	1 3/16	30.16	1 3/8
104H _ 3/8	3/8	2.50	63.5	0.52	13.2	1 5/16	33.34	1 1/2
104H _ 1/2	1/2	2.69	68.3	0.62	15.7	1 5/8	41.28	1 3/4
104H _ 3/4	3/4	3.12	79.2	0.87	22.1	1 7/8	47.63	2
104H _ 1	1	3.56	90.4	1.03	26.2	2 3/8	60.33	2 1/2

107 H HOLLOW HEX PLUGS

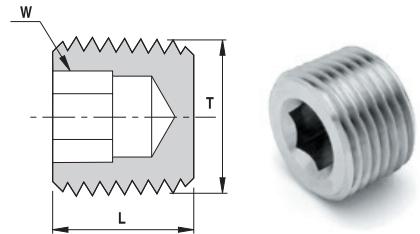

Ordering Information	T Male NPT Size	L		W Hex. Flat	
		inch	mm	inch	
107H _ 1/8	1/8	0.29	7.4	3/16	
107H _ 1/4	1/4	0.44	11.3	1/4	
107H _ 3/8	3/8	0.44	11.3	5/16	
107H _ 1/2	1/2	0.61	15.5	3/8	

107HOB HOLLOW HEX PLUG SAE/MS STRAIGHT THREAD BOSS *

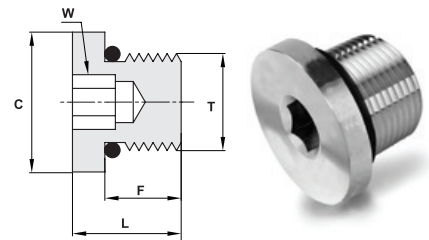

Ordering Information	T Straight Thread UN	L		F		C		W Hex. Flat	O-Ring**
		inch	mm	inch	mm	inch	mm		
107HOB _ 7/16-20	7/16-20	0.45	11.4	0.36	9.1	0.56	14.2	3/16	-904
107HOB _ 1/2-20	1/2-20	0.45	11.4	0.36	9.1	0.63	15.9	3/16	-905
107HOB _ 9/16-18	9/16-18	0.48	12.2	0.39	9.9	0.69	17.5	1/4	-906
107HOB _ 3/4-16	3/4-16	0.56	14.2	0.44	11.2	0.88	22.4	5/16	-908

* Per SAE J1926 and MS 16142.

** O-rings used are Fluorocarbon FKM 90 Durometer. Other O-ring materials are available on request.

108 H PIPE CAP

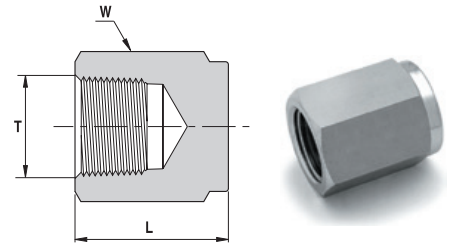

Ordering Information	T Female NPT Size	L		W Hex. Flat	
		inch	mm	inch	
108H_ 1/8	1/8	0.75	19.1	9/16	
108H_ 1/4	1/4	0.91	23.1	3/4	
108H_ 3/8	3/8	1.03	26.2	7/8	
108H_ 1/2	1/2	1.34	34.0	1 1/16	
108H_ 3/4	3/4	1.44	36.6	1 5/16	
108H_ 1	1	1.62	41.1	1 5/8	

110 H REDUCING BUSHING

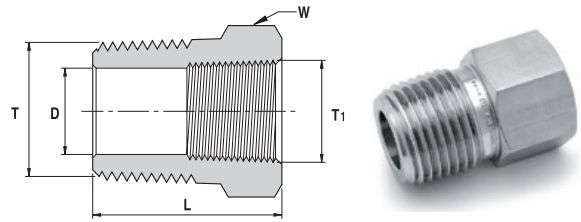

Ordering Information	T Male NPT Size	T1 Female NPT Size	L		D Min. Opening		W Hex. Flat
			inch	mm	inch	mm	inch
110H_ 1/8 X 1/16	1/8	1/16	1.03	26.2	0.19	4.8	7/16
110H_ 1/4 X 1/8	1/4	1/8	1.06	26.9	0.28	7.1	9/16
110H_ 3/8 X 1/8	3/8	1/8	0.86	21.8	0.34	8.6	11/16
110H_ 3/8 X 1/4	3/8	1/4	1.19	30.2	0.38	9.6	3/4
110H_ 1/2 X 1/8	1/2	1/8	1.08	27.4	0.34	8.6	7/8
110H_ 1/2 X 1/4	1/2	1/4	1.08	27.4	0.41	10.5	7/8
110H_ 1/2 X 3/8	1/2	3/8	1.41	35.8	0.47	11.9	7/8
110H_ 3/4 X 1/4	3/4	1/4	1.08	27.4	0.45	11.4	1 1/16
110H_ 3/4 X 3/8	3/4	3/8	1.08	27.4	0.56	14.2	1 1/16
110H_ 3/4 X 1/2	3/4	1/2	1.63	41.4	0.62	15.7	1 1/16
110H_ 1 X 1/4	1	1/4	1.37	34.8	0.41	10.5	1 3/8
110H_ 1 X 3/8	1	3/8	1.37	34.8	0.56	14.2	1 3/8
110H_ 1 X 1/2	1	1/2	1.37	34.8	0.69	17.4	1 3/8
110H_ 1 X 3/4	1	3/4	1.85	47.0	0.87	22.1	1 3/8
110H_ 1 1/4 X 1/2	1 1/4	1/2	1.46	37.1	0.69	17.4	1 3/4
110H_ 1 1/4 X 3/4	1 1/4	3/4	1.47	37.3	0.90	22.9	1 3/4
110H_ 1 1/4 X 1	1 1/4	1	1.94	49.3	1.09	27.8	1 3/4
110H_ 1 1/2 X 1/2	1 1/2	1/2	1.61	40.9	0.72	18.3	2 1/8
110H_ 1 1/2 X 3/4	1 1/2	3/4	1.61	40.9	0.90	22.9	2 1/8
110H_ 1 1/2 X 1	1 1/2	1	1.61	40.9	1.17	29.7	2 1/8
110H_ 1 1/2 X 1 1/4	1 1/2	1 1/4	2.31	58.7	1.50	38.1	2 1/8
110H_ 2 X 1/2	2	1/2	1.83	46.5	0.73	18.5	2 3/4
110H_ 2 X 3/4	2	3/4	1.83	46.5	0.94	23.9	2 3/4
110H_ 2 X 1	2	1	1.83	46.5	1.17	29.7	2 3/4
110H_ 2 X 1 1/4	2	1 1/4	1.83	46.5	1.50	38.1	2 3/4
110H_ 2 X 1 1/2	2	1 1/2	1.83	46.5	1.73	43.9	2 3/4

"D" Dimension is minimum opening. Dimensions are for reference only and are subject to change without notice.

110HOB

REDUCING BUSHING SAE/MS STRAIGHT THREAD BOSS *

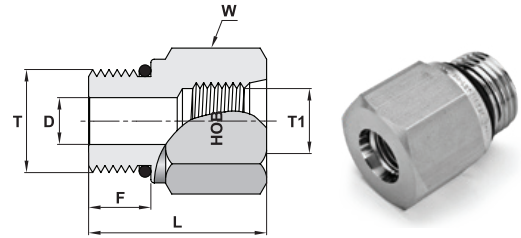

Ordering Information	T Straight Thread UN	T1 Straight Thread UN	D		L		F		W Hex. Flat inch	O-Ring**
			inch	mm	inch	mm	inch	mm		
110HOB _ 9/16-18 X 7/16-20	9/16-18	7/16-20	0.28	7.1	1.12	28.4	0.36	9.1	13/16	-906
110HOB _ 3/4-16 X 7/16-20	3/4-16	7/16-20	0.24	6.0	1.30	33.0	0.44	11.2	15/16	-908
110HOB _ 3/4-16 X 9/16-18	3/4-16	9/16-18	0.42	10.7	1.19	30.2	0.44	11.2	1	-908
110HOB _ 3/4-16 X 7/8-14	3/4-16	7/8-14	0.42	10.7	1.60	40.6	0.44	11.2	1 1/2	-908
110HOB _ 7/8-14 X 9/16-18	7/8-14	9/16-18	0.50	12.7	1.10	27.9	0.50	12.7	1	-910
110HOB _ 7/8-14 X 3/4-16	7/8-14	3/4-16	0.50	12.7	1.42	36.1	0.50	12.7	1 3/16	-910
110HOB _ 1 1/16-12 X 3/4-16	1 1/16-12	3/4-16	0.65	16.5	1.27	32.3	0.59	15.0	1 1/4	-912
110HOB _ 1 5/16-12 X 1 1/16-12	1 5/16-12	1 1/16-12	0.87	22.1	1.61	40.9	0.59	15.0	1 5/8	-916
110HOB _ 1 5/8-12 X 1 5/16-12	1 5/8-12	1 5/16-12	1.09	27.7	1.98	50.3	0.59	15.0	2 1/8	-920
110HOB _ 1 7/8-12 X 1 5/16-12	1 7/8-12	1 5/16-12	1.23	31.2	1.27	32.3	0.59	15.0	2 1/8	-924

113H

HEX LONG NIPPLE

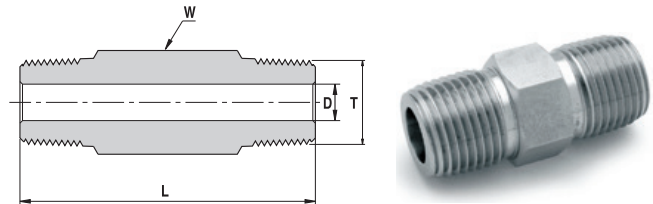

Ordering Information	T Male NPT Size	L Available Lengths (inch)						D Min. Opening		W Hex. Flat inch
		1.50	2.00	2.50	3.00	4.00	6.00	inch	mm	
113H _ 1/8 X 1.5 / 2 / 2.5 / 3	1/8	✓	✓	✓	✓	-	-	0.19	4.8	7/16
113H _ 1/4 X 1.5 / 2 / 2.5 / 3 / 4	1/4	✓	✓	✓	✓	✓	-	0.28	7.1	9/16
113H _ 3/8 X 1.5 / 2 / 2.5 / 3 / 4	3/8	✓	✓	✓	✓	✓	-	0.38	9.6	11/16
113H _ 1/2 X 2 / 3 / 4	1/2	-	✓	-	✓	✓	✓	0.47	11.9	7/8
113H _ 3/4 X 2 / 3 / 4	3/4	-	✓	-	✓	✓	-	0.62	15.8	1 1/16
113H _ 1 X 3 / 4	1	-	-	-	✓	✓	-	0.88	22.4	1 3/8

* Per SAE J1926 and MS 16142.

** O-rings used are Fluorocarbon FKM 90 Durometer. Other O-ring materials are available on request.

“D” Dimension is minimum opening. Dimensions are for reference only and are subject to change without notice.

116 H STREET ELBOW

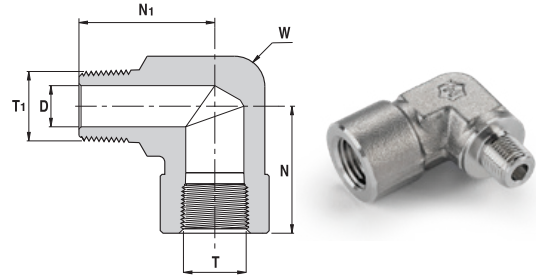

Ordering Information	T Female NPT Size	T1 Male NPT Size	N		N1		D Min. Opening		W Wrench Flat
			inch	mm	inch	mm	inch	mm	inch
116H_ 1/16 X 1/16	1/16	1/16	0.86	21.8	0.88	22.4	0.12	3.10	7/16
116H_ 1/8 X 1/16	1/8	1/16	1.04	26.4	0.87	22.1	0.12	3.10	5/8
116H_ 1/8 X 1/8	1/8	1/8	1.04	26.4	0.87	22.1	0.19	4.80	5/8
116H_ 1/4 X 1/8	1/4	1/8	1.17	29.7	1.00	25.4	0.19	4.80	11/16
116H_ 1/4 X 1/4	1/4	1/4	1.17	29.7	1.17	29.7	0.28	7.10	11/16
116H_ 3/8 X 1/4	3/8	1/4	1.42	36.1	1.26	32.0	0.28	7.10	15/16
116H_ 3/8 X 3/8	3/8	3/8	1.42	36.1	1.26	32.0	0.38	9.60	15/16
116H_ 1/2 X 1/4	1/2	1/4	1.56	39.6	1.38	35.1	0.28	7.10	1 1/8
116H_ 1/2 X 3/8	1/2	3/8	1.56	39.6	1.38	35.1	0.38	9.60	1 1/8
116H_ 1/2 X 1/2	1/2	1/2	1.56	39.6	1.56	39.6	0.47	11.9	1 1/8
116H_ 3/4 X 3/4	3/4	3/4	1.92	48.8	1.67	42.4	0.62	15.8	1 3/8
116H_ 1 X 1	1	1	1.83	46.5	1.94	49.3	0.86	21.8	1 11/16

119 H HEX REDUCING COUPLING

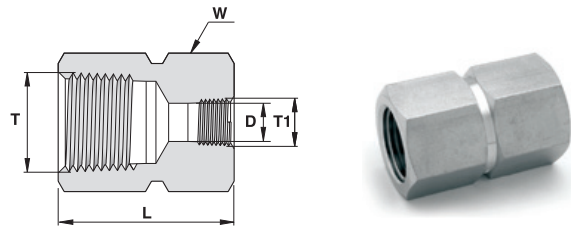

Ordering Information	T Female NPT Size	T1 Female NPT Size	L		D Min. Opening		W Hex. Flat
			inch	mm	inch	mm	inch
119H_ 1/4 X 1/8	1/4	1/8	1.22	31.0	0.31	7.8	3/4
119H_ 3/8 X 1/4	3/8	1/4	1.38	35.1	0.41	10.5	7/8
119H_ 1/2 X 1/8	1/2	1/8	1.56	39.6	0.31	7.8	1 1/16
119H_ 1/2 X 1/4	1/2	1/4	1.75	44.5	0.41	10.5	1 1/16
119H_ 1/2 X 3/8	1/2	3/8	1.78	45.2	0.56	14.2	1 1/16
119H_ 3/4 X 1/4	3/4	1/4	1.81	46.0	0.41	10.5	1 5/16
119H_ 3/4 X 1/2	3/4	1/2	2.06	52.3	0.69	17.4	1 5/16
119H_ 1 X 1/2	1	1/2	2.19	55.6	0.69	17.4	1 5/8
119H_ 1 X 3/4	1	3/4	2.25	57.2	0.90	22.9	1 5/8

"D" Dimension is minimum opening. Dimensions are for reference only and are subject to change without notice.

120 H ADAPTER NPT

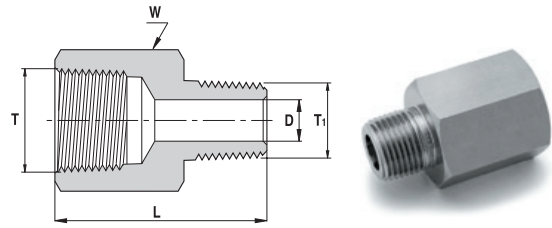

Ordering Information	T Female NPT Size	T1 Male NPT Size	L		D Min. Opening		W Hex. Flat
			inch	mm	inch	mm	
120H _ 1/8 X 1/16	1/8	1/16	1.09	27.7	0.12	3.0	9/16
120H _ 1/8 X 1/8	1/8	1/8	1.10	27.9	0.19	4.8	9/16
120H _ 1/4 X 1/8	1/4	1/8	1.26	32.0	0.19	4.8	3/4
120H _ 1/4 X 1/4	1/4	1/4	1.40	35.6	0.28	7.1	3/4
120H _ 3/8 X 1/8	3/8	1/8	1.33	33.8	0.19	4.8	7/8
120H _ 3/8 X 1/4	3/8	1/4	1.50	38.1	0.28	7.1	7/8
120H _ 3/8 X 3/8	3/8	3/8	1.51	38.4	0.38	9.6	7/8
120H _ 1/2 X 1/8	1/2	1/8	1.58	40.1	0.19	4.8	1 1/16
120H _ 1/2 X 1/4	1/2	1/4	1.76	44.7	0.28	7.1	1 1/16
120H _ 1/2 X 3/8	1/2	3/8	1.75	44.5	0.37	9.5	1 1/16
120H _ 1/2 X 1/2	1/2	1/2	1.94	49.3	0.47	11.9	1 1/16
120H _ 3/4 X 1/4	3/4	1/4	1.85	47.0	0.28	7.1	1 5/16
120H _ 3/4 X 3/8	3/4	3/8	1.82	46.2	0.37	9.5	1 5/16
120H _ 3/4 X 1/2	3/4	1/2	2.02	51.3	0.47	11.9	1 5/16
120H _ 3/4 X 3/4	3/4	3/4	2.02	51.3	0.62	15.8	1 5/16
120H _ 1 X 1/4	1	1/4	1.96	49.8	0.28	7.1	1 5/8
120H _ 1 X 1/2	1	1/2	2.16	54.9	0.47	11.9	1 5/8
120H _ 1 X 3/4	1	3/4	2.17	55.1	0.62	15.7	1 5/8
120H _ 1 X 1	1	1	2.28	57.9	0.86	21.8	1 5/8

120 HNR ADAPTER NPT TO BSPT

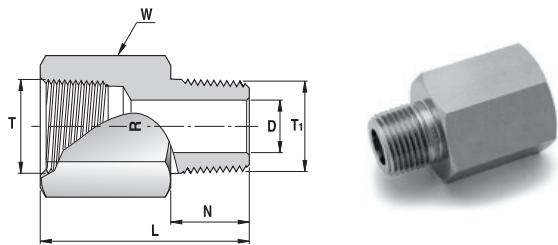

Ordering Information	T Female NPT Size	T1 Male BSPT ISO 7/1, BS21 Size	L		N		D Min. Opening		W Hex. Flat
			inch	mm	inch	mm	inch	mm	
120HNR _ 1/8	1/8	1/8-28	1.09	27.7	0.38	9.7	0.19	4.8	9/16
120HNR _ 1/4	1/4	1/4-19	1.42	36.1	0.56	14.2	0.28	7.1	3/4
120HNR _ 3/8	3/8	3/8-19	1.50	38.1	0.56	14.2	0.38	9.6	7/8
120HNR _ 1/2	1/2	1/2-14	1.94	49.3	0.75	19.0	0.47	11.9	1 1/16
120HNR _ 3/4	3/4	3/4-14	2.02	51.3	0.75	19.0	0.62	15.8	1 5/16
120HNR _ 1	1	1-11	2.30	58.4	0.94	23.9	0.88	22.4	1 5/8

"D" Dimension is minimum opening. Dimensions are for reference only and are subject to change without notice.

120 HNG ADAPTER NPT TO BSPP

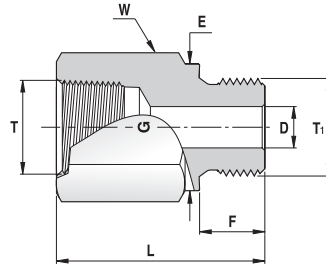

Ordering Information	T Female NPT Size	T1 Male BSPP ISO 228/1, BS 2779	L		F		E Dia.		D Min. Opening		W Hex. Flat inch
			inch	mm	inch	mm	inch	mm	inch	mm	
120HNG _ 1/8	1/8	1/8-28	0.99	25.1	0.28	7.1	0.54	13.8	0.16	4.1	9/16
120HNG _ 1/4	1/4	1/4-19	1.32	33.5	0.44	11.2	0.70	18.0	0.23	5.8	3/4
120HNG _ 3/8	3/8	3/8-19	1.41	35.8	0.44	11.2	0.85	21.8	0.31	7.9	7/8
120HNG _ 1/2	1/2	1/2-14	1.74	44.2	0.56	14.2	1.02	26.0	0.47	11.9	1 1/16
120HNG _ 3/4	3/4	3/4-14	1.89	48.0	0.62	15.7	1.26	32.0	0.62	15.7	1 5/16
120HNG _ 1	1	1-11	2.10	53.3	0.72	18.3	1.53	39.0	0.78	19.8	1 5/8

Gaskets For BSPP Parallel Threads Sealing, see Let-Lok catalog page 81

120HNOB ADAPTER NPT TO SAE/MS STRAIGHT THREAD BOSS*

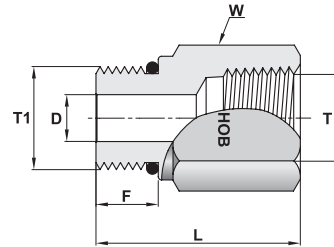

Ordering Information	T Female NPT Size	T1 Straight Thread UN	D		L		F		W Hex. Flat inch	O-Ring**
			inch	mm	inch	mm	inch	mm		
120HNOB _ 1/4 X 7/16-20	1/4	7/16-20	0.20	5.1	1.32	33.5	0.36	9.1	3/4	-904
120HNOB _ 3/8 X 9/16-18	3/8	9/16-18	0.28	7.1	1.39	35.3	0.39	9.9	15/16	-906
120HNOB _ 1/2 X 3/4-16	1/2	3/4-16	0.42	10.7	1.76	44.7	0.44	11.2	1 1/16	-908
120HNOB _ 3/4 X 1 1/16-12	3/4	1 1/16-12	0.66	16.7	1.99	50.5	0.59	15.0	1 3/8	-912
120HNOB _ 1 X 1 5/16-12	1	1 5/16-12	0.88	22.3	2.12	53.8	0.59	15.0	1 5/8	-916

120 HRN ADAPTER BSPT TO NPT

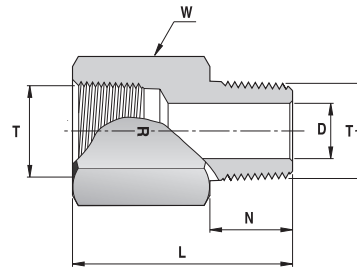

Ordering Information	T Female BSPT ISO 7/1, BS21	T1 Male NPT size	L		N		D Min. Opening		W Hex. Flat inch
			inch	mm	inch	mm	inch	mm	
120HRN _ 1/4	1/4-19	1/4	1.43	36.3	0.56	14.2	0.28	7.1	3/4
120HRN _ 3/8	3/8-19	3/8	1.51	38.4	0.56	14.2	0.38	9.6	7/8
120HRN _ 1/2	1/2-14	1/2	1.96	49.8	0.75	19.1	0.47	11.9	1 1/16

* Per SAE J1926 and MS 16142.

** O-rings used are Fluorocarbon FKM 90 Durometer. Other O-ring materials are available on request.

"D" Dimension is minimum opening. Dimensions are for reference only and are subject to change without notice.

120 HGN

**GAUGE ADAPTER
BSPP TO NPT**

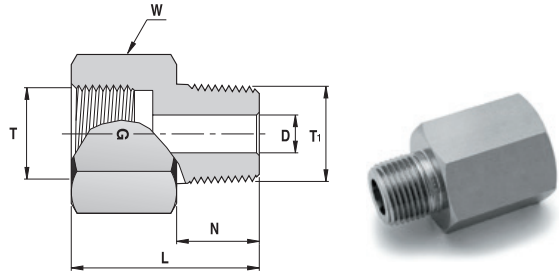

Ordering Information	T Female BSPP ISO 228/1, BS 2779 Size	T1 Male NPT Size	L		N		D Min. Opening		W Hex. Flat
			inch	mm	inch	mm	inch	mm	inch
120HGN _ 1/4	1/4-19	1/4	1.19	30.2	0.56	14.2	0.22	5.6	3/4
120HGN _ 3/8	3/8-19	3/8	1.27	32.3	0.56	14.2	0.26	6.6	15/16
120HGN _ 1/2	1/2-14	1/2	1.65	41.9	0.75	19.0	0.28	7.1	1 1/16

Gaskets For BSPP Parallel Threads Sealing, see Let-Lok catalog page 81

121 H

PIPE PLUG NPT

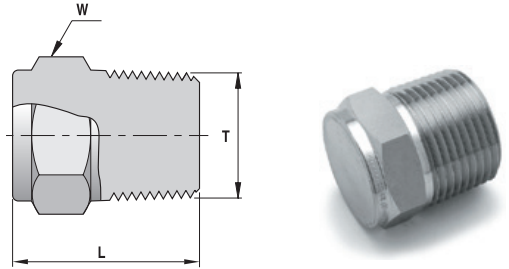

Ordering Information	T Male NPT Size	L		W Hex. Flat
		inch	mm	inch
121H _ 1/16	1/16	0.75	19.0	5/16
121H _ 1/8	1/8	0.75	19.0	7/16
121H _ 1/4	1/4	0.96	24.4	9/16
121H _ 3/8	3/8	0.99	25.2	11/16
121H _ 1/2	1/2	1.21	30.7	7/8
121H _ 3/4	3/4	1.21	30.7	1 1/16
121H _ 1	1	1.50	38.1	1 3/8

121HOB

**HEX HEAD PLUG SAE/MS
STRAIGHT THREAD BOSS***

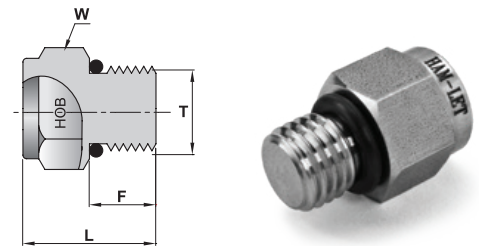

Ordering Information	T Straight Thread UN	L		F		W Hex. Flat	O-Ring**
		inch	mm	inch	mm	inch	
121HOB _ 5/16-24	5/16-24	0.70	17.8	0.30	7.6	7/16	-902
121HOB _ 7/16-20	7/16-20	0.76	19.3	0.36	9.1	9/16	-904
121HOB _ 9/16-18	9/16-18	0.82	20.8	0.39	9.9	11/16	-906
121HOB _ 3/4-16	3/4-16	0.89	22.6	0.44	11.2	7/8	-908
121HOB _ 1 1/16-12	1 1/16-12	1.12	28.4	0.59	15.0	1 1/4	-912
121HOB _ 1 5/16-12	1 5/16-12	1.18	30.0	0.59	15.0	1 1/2	-916

* Per SAE J1926 and MS 16142.

** O-rings used are Fluorocarbon FKM 90 Durometer. Other O-ring materials are available on request.

“D” Dimension is minimum opening. Dimensions are for reference only and are subject to change without notice.

122 H
HEX NIPPLE

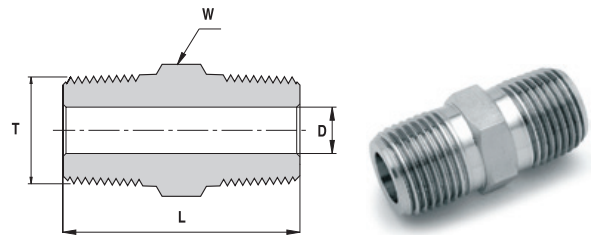

Ordering Information	T Male NPT Size	L		D Min. Opening		W Hex. Flat
		inch	mm	inch	mm	
122H _ 1/16	1/16	1.01	25.7	0.12	3.0	5/16
122H _ 1/8	1/8	1.01	25.7	0.19	4.8	7/16
122H _ 1/4	1/4	1.40	35.6	0.28	7.1	9/16
122H _ 3/8	3/8	1.43	36.3	0.38	9.6	11/16
122H _ 1/2	1/2	1.84	46.7	0.47	11.9	7/8
122H _ 3/4	3/4	1.84	46.7	0.62	15.8	1 1/16
122H _ 1	1	2.32	58.9	0.87	22.1	1 3/8

122 HNR
HEX NIPPLE NPT TO BSPT

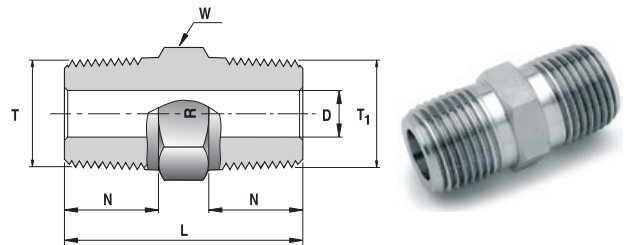

Ordering Information	T Male NPT Size	T1 Male BSPT ISO 7/1, BS21 Size	L		N		D Min. Opening		W Hex. Flat
			inch	mm	inch	mm	inch	mm	
122HNR _ 1/8	1/8	1/8-28	1.01	25.6	0.38	9.7	0.19	4.8	7/16
122HNR _ 1/4	1/4	1/4-19	1.40	35.6	0.56	14.2	0.28	7.1	9/16
122HNR _ 3/8	3/8	3/8-19	1.43	36.3	0.56	14.2	0.38	9.6	11/16
122HNR _ 1/2	1/2	1/2-14	1.84	46.7	0.75	19.0	0.47	11.9	7/8
122HNR _ 3/4	3/4	3/4-14	1.84	46.7	0.75	19.0	0.62	15.8	1 1/16
122HNR _ 1	1	1-11	2.32	58.9	0.94	23.9	0.87	22.1	1 3/8

“D” Dimension is minimum opening. Dimensions are for reference only and are subject to change without notice.

122 HNG
HEX NIPPLE NPT TO BSPP

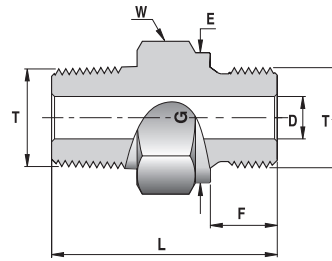

Ordering Information	T Male NPT Size	T1 Male BSPP ISO 228/1, BS 2779	L		F		E		D Min. Opening		W Hex. Flat
			inch	mm	inch	mm	inch	mm	inch	mm	inch
122HNG _ 1/8	1/8	1/8-28	1.07	27.2	0.28	7.1	0.54	13.8	0.16	4.1	9/16
122HNG _ 1/4	1/4	1/4-19	1.44	36.6	0.44	11.2	0.71	18.0	0.23	5.8	3/4
122HNG _ 3/8	3/8	3/8-19	1.47	37.3	0.44	11.2	0.85	21.8	0.31	7.9	7/8
122HNG _ 1/2	1/2	1/2-14	1.78	45.2	0.56	14.2	1.02	26.0	0.47	11.9	1 1/16
122HNG _ 3/4	3/4	3/4-14	1.95	49.5	0.62	15.7	1.26	32.0	0.62	15.8	1 5/16
122HNG _ 1	1	1-11	2.26	57.4	0.72	18.3	1.53	39.0	0.78	19.8	1 5/8

Gaskets For BSPP Parallel Threads Sealing, see Let-Lok catalog page 81

122HNOB
**HEX NIPPLE NPT TO SAE/MS
 STRAIGHT THREAD BOSS ***

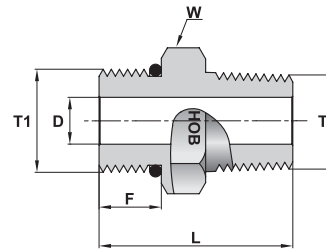

Ordering Information	T Male NPT Size	T1 Straight Thread UN	D		L		F		W Hex. Flat	O-Ring**
			inch	mm	inch	mm	inch	mm	inch	
122HNOB _ 1/4 X 7/16-20	1/4	7/16-20	0.20	5.1	1.20	30.5	0.36	9.1	9/16	-904
122HNOB _ 3/8 X 9/16-18	3/8	9/16-18	0.28	7.1	1.26	32.0	0.39	9.9	11/16	-906
122HNOB _ 1/2 X 3/4-16	1/2	3/4-16	0.42	10.7	1.53	38.9	0.44	11.2	7/8	-908
122HNOB _ 3/4 X 1 1/16-12	3/4	1 1/16-12	0.62	15.7	1.75	44.4	0.59	15.0	1 1/4	-912
122HNOB _ 1 X 1 5/16-12	1	1 5/16-12	0.88	22.4	2.00	50.8	0.59	15.0	1 1/2	-916

122HCN
CLOSE NIPPLE

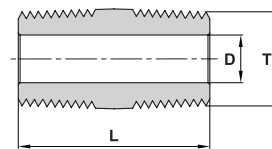

Ordering Information	T Male NPT Size	D		L	
		inch	mm	inch	mm
122HCN _ 1/8	1/8	0.19	4.8	0.75	19.1
122HCN _ 1/4	1/4	0.28	7.1	1.12	28.4
122HCN _ 3/8	3/8	0.38	9.6	1.12	28.4
122HCN _ 1/2	1/2	0.47	11.9	1.50	38.1
122HCN _ 3/4	3/4	0.62	15.7	1.50	38.1
122HCN _ 1	1	0.88	22.4	1.88	47.8

* Per SAE J1926 and MS 16142.

** O-rings used are Fluorocarbon FKM 90 Durometer. Other O-ring materials are available on request.

"D" Dimension is minimum opening. Dimensions are for reference only and are subject to change without notice.

123 H

REDUCING NIPPLE

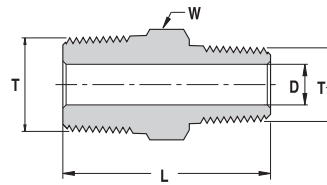

Ordering Information	T Male NPT Size	T1 Male NPT Size	L		D Min. Opening		W Hex. Flat
			inch	mm	inch	mm	
123H _ 1/8 X 1/16	1/8	1/16	1.01	25.7	0.12	3.0	7/16
123H _ 1/4 X 1/8	1/4	1/8	1.22	31.0	0.19	4.8	9/16
123H _ 3/8 X 1/8	3/8	1/8	1.25	31.8	0.19	4.8	11/16
123H _ 3/8 X 1/4	3/8	1/4	1.43	36.3	0.28	7.1	11/16
123H _ 1/2 X 1/8	1/2	1/8	1.47	37.3	0.19	4.8	7/8
123H _ 1/2 X 1/4	1/2	1/4	1.65	41.9	0.28	7.1	7/8
123H _ 1/2 X 3/8	1/2	3/8	1.65	41.9	0.38	9.6	7/8
123H _ 3/4 X 1/4	3/4	1/4	1.65	41.9	0.28	7.1	1 1/16
123H _ 3/4 X 1/2	3/4	1/2	1.84	46.7	0.47	11.9	1 1/16
123H _ 1 X 1/2	1	1/2	2.13	54.1	0.47	11.9	1 3/8
123H _ 1 X 3/4	1	3/4	2.13	54.1	0.62	15.8	1 3/8

3600 H

BRANCH TEE

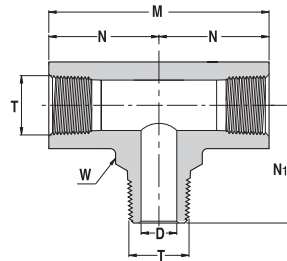

Ordering Information	T Male & Female NPT	M		N		N1		D		W Wrench Flat
		inch	mm	inch	mm	inch	mm	inch	mm	
3600H _ 1/8	1/8	2.08	52.8	1.04	26.4	0.87	22.1	0.19	4.8	5/8
3600H _ 1/4	1/4	2.34	59.4	1.17	29.7	1.17	29.7	0.28	7.1	13/16
3600H _ 3/8	3/8	2.84	72.1	1.42	36.1	1.26	32.0	0.38	9.6	15/16
3600H _ 1/2	1/2	3.12	79.2	1.56	39.6	1.56	39.6	0.47	11.9	1 1/8

“D” Dimension is minimum opening. Dimensions are for reference only and are subject to change without notice.

3750 H
STREET TEE

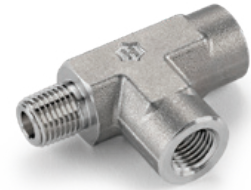
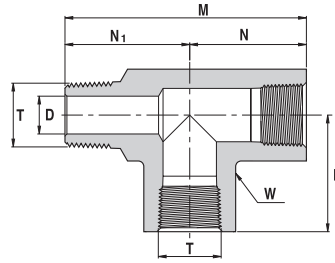

Ordering Information	T Male & Female NPT	M		N		N1		D Min. Opening		W Wrench Flat
		inch	mm	inch	mm	inch	mm	inch	mm	inch
3750H _ 1/8	1/8	1.91	48.5	1.04	26.4	0.87	22.1	0.19	4.8	5/8
3750H _ 1/4	1/4	2.34	59.4	1.17	29.7	1.17	29.7	0.28	7.1	13/16
3750H _ 3/8	3/8	2.68	68.1	1.42	36.1	1.26	32.0	0.38	9.6	15/16
3750H _ 1/2	1/2	3.12	79.2	1.56	39.6	1.56	39.6	0.47	11.9	1 1/8

130 HM
**MALE TO HOSE
CONNECTOR**

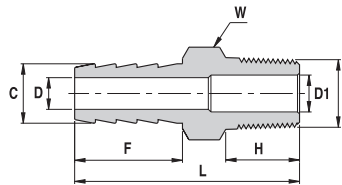

Ordering Information	Hose I.D.	T Male NPT Size	C		D		D1		F		H		L		W Hex. Flat
			inch	mm	inch	mm	inch	mm	inch	mm	inch	mm	inch	mm	inch
130HM _ 1/8 X 1/8	1/8	1/8	0.15	3.80	0.08	2.0	0.19	4.80	0.40	10.2	0.38	9.70	1.08	27.4	7/16
130HM _ 1/8 X 1/4	1/8	1/4	0.15	3.80	0.08	2.0	0.28	7.10	0.40	10.2	0.56	14.2	1.26	32.0	9/16
130HM _ 3/16 X 1/8	3/16	1/8	0.23	5.84	0.12	3.0	0.12	3.00	0.59	15.0	0.38	9.70	1.27	32.3	7/16
130HM _ 3/16 X 1/4	3/16	1/4	0.23	5.84	0.12	3.0	0.28	7.10	0.59	15.0	0.56	14.2	1.45	36.8	9/16
130HM _ 1/4 X 1/8	1/4	1/8	0.30	7.62	0.19	4.8	0.19	4.80	0.79	20.1	0.38	9.70	1.47	37.3	7/16
130HM _ 1/4 X 1/4	1/4	1/4	0.30	7.62	0.19	4.8	0.19	4.80	0.79	20.1	0.56	14.2	1.65	41.9	9/16
130HM _ 1/4 X 3/8	1/4	3/8	0.30	7.62	0.19	4.8	0.19	4.80	0.79	20.1	0.56	14.2	1.66	42.2	11/16
130HM _ 1/4 X 1/2	1/4	1/2	0.30	7.62	0.19	4.8	0.47	11.9	0.79	20.1	0.75	19.0	1.85	47.0	7/8
130HM _ 5/16 X 1/8	5/16	1/8	0.38	9.65	0.19	4.8	0.19	4.80	0.87	22.1	0.38	9.70	1.55	39.4	7/16
130HM _ 5/16 X 1/4	5/16	1/4	0.38	9.65	0.19	4.8	0.19	4.80	0.87	22.1	0.56	14.2	1.73	43.9	9/16
130HM _ 5/16 X 3/8	5/16	3/8	0.38	9.65	0.19	4.8	0.37	9.50	0.87	22.1	0.56	14.2	1.74	44.2	11/16
130HM _ 5/16 X 1/2	5/16	1/2	0.38	9.65	0.19	4.8	0.47	11.9	0.87	22.1	0.75	19.0	1.96	49.8	7/8
130HM _ 3/8 X 1/4	3/8	1/4	0.45	11.43	0.30	7.6	0.30	7.60	0.87	22.1	0.56	14.2	1.73	43.9	9/16
130HM _ 3/8 X 3/8	3/8	3/8	0.45	11.43	0.30	7.6	0.30	7.60	0.87	22.1	0.56	14.2	1.74	44.2	11/16
130HM _ 3/8 X 1/2	3/8	1/2	0.45	11.43	0.30	7.6	0.30	7.60	0.87	22.1	0.75	19.0	1.96	49.8	7/8
130HM _ 1/2 X 1/4	1/2	1/4	0.60	15.24	0.37	9.5	0.28	7.10	0.94	23.8	0.56	14.2	1.80	45.7	11/16
130HM _ 1/2 X 3/8	1/2	3/8	0.60	15.24	0.37	9.5	0.37	9.50	0.94	23.8	0.56	14.2	1.81	46.0	11/16
130HM _ 1/2 X 1/2	1/2	1/2	0.60	15.24	0.37	9.5	0.37	9.50	0.94	23.8	0.75	19.0	2.03	51.6	7/8
130HM _ 5/8 X 1/2	5/8	1/2	0.75	19.10	0.47	11.9	0.47	11.9	0.98	24.9	0.75	19.0	2.07	52.6	1 1/16
130HM _ 5/8 X 3/4	5/8	3/4	0.75	19.10	0.50	12.7	0.63	16.0	0.98	24.9	0.75	19.0	2.07	52.6	1 1/16
130HM _ 3/4 X 1/2	3/4	1/2	0.90	22.86	0.63	16.0	0.47	11.9	1.05	26.7	0.75	19.0	2.14	54.4	1 1/16
130HM _ 3/4 X 3/4	3/4	3/4	0.90	22.86	0.63	16.0	0.63	16.0	1.05	26.7	0.75	19.0	2.14	54.4	1 1/16
130HM _ 3/4 X 1	3/4	1	0.90	22.86	0.63	16.0	0.88	22.4	1.05	26.7	0.94	23.9	2.43	61.7	1 3/8
130HM _ 1 X 3/4	1	3/4	1.2	30.48	0.88	22.4	0.63	16.0	1.19	30.2	0.75	19.0	2.38	60.5	1 3/8
130HM _ 1 X 1	1	1	1.2	30.48	0.88	22.4	0.88	22.4	1.19	30.2	0.94	23.9	2.57	65.3	1 3/8

"D" Dimension is minimum opening. Dimensions are for reference only and are subject to change without notice.

130 HF FEMALE HOSE CONNECTOR

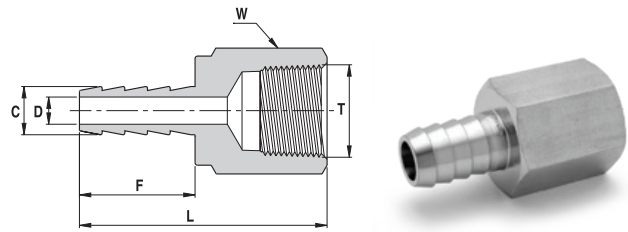

Ordering Information	Hose I.D.	T NPT Size	C		D		F		L		W Hex. Flat
			inch	mm	inch	mm	inch	mm	inch	mm	
130HF _ 1/8 X 1/8	1/8	1/8	0.15	3.80	0.08	2.00	0.40	10.2	1.11	28.2	9/16
130HF _ 1/8 X 1/4	1/8	1/4	0.15	3.80	0.08	2.00	0.40	10.2	1.26	32.0	3/4
130HF _ 3/16 X 1/8	3/16	1/8	0.23	5.84	0.12	3.00	0.59	15.0	1.29	32.8	9/16
130HF _ 3/16 X 1/4	3/16	1/4	0.23	5.84	0.12	3.00	0.59	15.0	1.44	36.6	3/4
130HF _ 1/4 X 1/8	1/4	1/8	0.30	7.62	0.19	4.80	0.79	20.1	1.47	37.3	9/16
130HF _ 1/4 X 1/4	1/4	1/4	0.30	7.62	0.19	4.80	0.79	20.1	1.64	41.7	3/4
130HF _ 1/4 X 3/8	1/4	3/8	0.30	7.62	0.19	4.80	0.79	20.1	1.71	43.4	7/8
130HF _ 5/16 X 1/4	5/16	1/4	0.38	9.65	0.19	4.80	0.87	22.1	1.73	43.9	3/4
130HF _ 5/16 X 3/8	5/16	3/8	0.38	9.65	0.19	4.80	0.87	22.1	1.82	46.2	7/8
130HF _ 3/8 X 1/4	3/8	1/4	0.45	11.43	0.30	7.60	0.87	22.1	1.69	42.9	3/4
130HF _ 3/8 X 3/8	3/8	3/8	0.45	11.43	0.30	7.60	0.87	22.1	1.78	45.2	7/8
130HF _ 3/8 X 1/2	3/8	1/2	0.45	11.43	0.30	7.60	0.87	22.1	2.03	51.6	1 1/16
130HF _ 1/2 X 1/2	1/2	1/2	0.60	15.24	0.38	9.70	0.94	23.9	2.13	54.1	1 1/16

"D" Dimension is minimum opening.

130 LT TUBE TO HOSE CONNECTOR

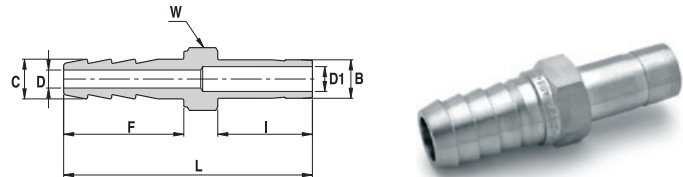

Ordering Information	Hose I.D.	B Tube Size	C		D		D1		F		I		L		W Hex. Flat
			inch	mm	inch	mm	inch	mm	inch	mm	inch	mm			
130LT _ 1/8 X 1/8	1/8	1/8	0.15	3.80	0.08	2.00	0.08	2.00	0.40	10.2	0.53	13.5	1.35	34.3	5/16
130LT _ 1/8 X 1/4	1/8	1/4	0.15	3.80	0.08	2.00	0.17	4.20	0.40	10.2	0.62	15.7	1.44	36.6	3/8
130LT _ 1/4 X 1/4	1/4	1/4	0.30	7.62	0.19	4.80	0.17	4.20	0.79	20.1	0.62	15.7	1.83	46.5	7/16
130LT _ 1/4 X 3/8	1/4	3/8	0.30	7.62	0.19	4.80	0.27	6.85	0.79	20.1	0.69	17.5	1.90	48.3	7/16
130LT _ 1/4 X 6 MM	1/4	6mm	0.30	7.62	0.19	4.80	0.16	4.00	0.79	20.1	0.62	15.7	1.86	47.2	7/16
130LT _ 5/16 X 1/4	5/16	1/4	0.37	9.40	0.19	4.80	0.17	4.20	0.87	22.1	0.62	15.7	1.91	48.5	7/16
130LT _ 3/8 X 3/8	3/8	3/8	0.45	11.43	0.30	7.60	0.27	6.85	0.87	22.1	0.69	17.5	1.98	50.3	9/16
130LT _ 3/8 X 1/2	3/8	1/2	0.45	11.43	0.30	7.60	0.37	9.40	0.87	22.1	0.91	23.1	2.20	55.9	5/8
130LT _ 1/2 X 3/8	1/2	3/8	0.60	15.24	0.38	9.70	0.27	6.85	0.94	23.9	0.69	17.5	2.05	52.1	11/16
130LT _ 1/2 X 1/2	1/2	1/2	0.60	15.24	0.38	9.70	0.37	9.40	0.94	23.9	0.91	23.1	2.27	57.7	11/16
130LT _ 3/4 X 3/4	3/4	3/4	0.90	22.86	0.63	16.0	0.59	15.0	1.05	26.7	0.97	24.6	2.44	62.0	1 1/16

"D" Dimension is minimum opening. Dimensions are for reference only and are subject to change without notice.

